



FEATURES

	IL	OL	3.5
» HD Voice (Wide-Band Speech)	•	•	•
» Connects to Headsets, Phones, & Notebooks with Bluetooth Wireless Technology	•	•	
» Connects to Phones and Notebooks with 4-conductor 3.5mm Headset Interface			•
» 2.4 GHz Encrypted Digital Wireless	•		
» 3-pin XLR Male and Female Intercom Jacks	•		
» Uses Standard 4-Pin and 5-Pin Male or Female Intercom Headset Jacks		•	•
» Send and Receive Volume Controls	•	•	•
» Push-On, Push-Off Talk Button	•	•	•
» Recessed Sidetone Level control	•	•	•
» Intercom Powered with 9 Volt Battery Backup	•		
» Number of Hours on one 9 Volt Battery	N/A	10 Hrs	>20 Hrs

Interloop and Outerloop shown for comparison

IL = Interloop **OL** = Outerloop **3.5** = Outerloop 3.5

Stay in the Loop.

Interloop™ works with industry standard Two-Wire, Party-Line intercoms, connecting to the existing intercom system like any other belt pack. Utilizing Bluetooth Wireless Technology, a rear panel switch selects Headset or Phone connection. Headset mode allows you to connect to a Bluetooth enabled headset for wireless freedom. Phone mode allows you to connect to a wireless phone to let others join in, or connect to a notebook or laptop to provide remote voice access using VoIP applications such as Skype™.

Battery Backup. Powered by the intercom system, yet uses less current than a typical belt pack. Includes 9 VDC battery backup, holding the wireless connection while changing cables.

Increased Range. While Interloop™ will work with any Bluetooth enabled headset, most headsets were designed to work a short distance from the phone. JK Audio BSET-HS1 Wireless Headset offers increased range and performance making it the perfect match.

HD Voice. While standard phone calls have a narrow bandwidth of 300 Hz to 3.4 kHz, HD Voice calls offer 50 Hz to 7 kHz bandwidth. The additional 1.5 octaves on the low end gives voice a more natural sound, while the additional upper octave dramatically improves speech clarity and intelligibility.

Wireless HD Calls. To take advantage of this extended bandwidth, both phones on the call must support HD Voice, and both phones must be on the same carrier, in coverage areas that support HD Voice.

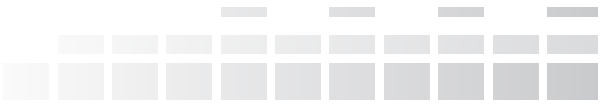

REAR VIEW

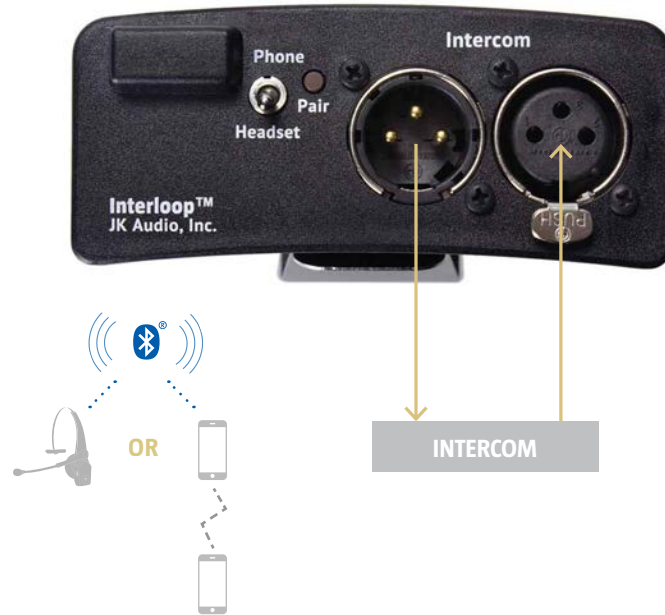

SPECIFICATIONS

XLR Intercom Channel

Output Level:	0 dBu (775 mV) nominal
Terminating Impedance:	200 ohms
Bridging Impedance:	>15k ohms
Pin 1:	Common
Pin 2:	+30 VDC (+12 VDC min) 35 mA
Pin 3:	Audio

Bluetooth Wireless Technology

Standard:	Bluetooth 3.0
Profile:	Hands Free (HF)
Range:	66 feet (20 meters)
Frequency Response:	Hands-Free (Full Duplex): 300 Hz– 3.4 kHz Hands-Free (Full Duplex HD): 50 Hz– 7 kHz
Power:	Intercom System with 9 VDC Battery backup
Size:	4.7" x 3.75" x 1.65" (12 x 9.5 x 4.2 cm)
Weight:	10 ounces (275 grams)



The Bluetooth word mark and logos are owned by the Bluetooth SIG, Inc. and any use of such marks by JK Audio, Inc. is under license.

