

## Warranty

Innkeeper 2/4 is covered by a 2-year warranty to be free from defective workmanship and materials. In the event that the innkeeper 2/4 needs repair, you must call us to get an authorization, and then carefully pack and ship it to us. You will pay for shipping to us and we will pay for return back to you, UPS ground. No free repairs will be made if the defect was caused by misuse, weather conditions, or other cause, except for defective workmanship or materials.

THERE ARE NO EXPRESSED OR IMPLIED WARRANTIES WHICH EXTEND BEYOND THE WARRANTY HERE MADE.

# innkeeper 2

# innkeeper 4

## Multi Line Digital Hybrids



## User Guide

10/06

---

JK Audio, Inc. 1311 E 6th Street, Sandwich, IL 60548 USA  
Voice: (815) 786-2929 Toll Free: 800-JK-Audio Fax: 815-786-8502  
Info@jkaudio.com www.jkaudio.com  
Copyright © 2006 JK Audio. All Rights Reserved.

---

# JK Audio

## Introduction

Innkeeper multi line digital hybrids will allow you to send and receive audio over analog telephone lines. While this may seem like a simple task that any telephone can do, the challenge is getting the best quality audio from such a limited audio path.

### What is a Digital Hybrid?

A digital hybrid connects audio signals to a standard analog telephone line without the variations in quality found with analog hybrids. The main function of a hybrid is to bring in the caller's voice from the phone line, as clear and clean as possible. In the real world, when you send your voice down the telephone line it has a tendency to bleed over into the caller's audio. The hybrid must adapt to the phone line in order to properly separate transmit and receive audio. We use a 16 bit DSP to continuously monitor the phone line and audio signals to deliver excellent separation. Our dual-convergence algorithm can achieve excellent trans-hybrid loss, typically exceeding 50 dB, without any setup.

### Ready to go?

The innkeeper 2/4 features diagrams will help you pinpoint any minor questions that you may have. If this is your first exposure to a hybrid, we suggest that you read the entire manual to allow you to take advantage of all these features.

### Any Questions?

Before you pick up the phone... Please thumb through the rest of this manual. You might find those deep technical questions are covered on later pages.

## FCC Registration

b) The telephone equipment's FCC registration number. This can be found on the bottom of your telephone equipment, and,

c) the ringer equivalence number (REN) for this equipment.

The REN is used to determine the quantity of devices which will be connected to the telephone line. Excessive RENs on the telephone line may result in the devices not ringing in response to an incoming call. In most, but not all areas, the sum of the RENs should not exceed 5.0. To be certain of the number of devices that may be connected to the line, as determined by the total RENs, contact the local telephone company.

### 3. Repair Instructions

If it is determined that your telephone equipment is malfunctioning, the FCC requires that it not be used and that it be unplugged from the modular outlet until the problem has been corrected. Repairs to this telephone equipment can only be made by the manufacturer or its authorized agents or by others who may be authorized by the FCC. For repair procedures, follow the instructions outlined under the warranty section of the manual.

### 4. Rights of the telephone company

If telephone equipment is causing harm to the network, the telephone company may temporarily discontinue your telephone service. If possible, they'll notify you before they interrupt service. If advanced notice isn't practical, you'll be notified as soon as possible. You'll be given the opportunity to correct the problem, and you'll be informed of your right to file a complaint with the FCC.

Your telephone company may make changes in its facilities, equipment, operations or procedures that could affect the proper functioning of your JK Audio product. If such changes are planned, you'll be notified by your telephone company.

## FCC Part 15 Compliance

This equipment has been tested and found to comply with the limits for a Class A digital device, pursuant to Part 15 of the FCC Rules. These limits are designed to provide reasonable protection against harmful interference when the equipment is operated in a commercial environment. This equipment generates, uses, and can radiate radio frequency energy and, if not installed and used in accordance with the instruction manual, may cause harmful interference to radio communications. Operation of this equipment in a residential area is likely to cause harmful interference in which case the user will be required to correct the interference at his own expense.

Changes or modifications not expressly approved by JK Audio can void the user's authority to operate the equipment.

## FCC Registration

Your new JK Audio product has been registered with the Federal Communications Commission (FCC). This product complies with the standards in Part 68 of the FCC rules.

### 1. Connection and use with the nationwide telephone network

The FCC requires that you connect this telephone equipment to the national telephone network through a USOC RJ-11C modular telephone jack.

This equipment may not be used with Party Line Service or Coin Telephone Lines

This equipment is hearing aid compatible.

### 2. Information for the telephone company

Upon request from your local telephone company, you are required to provide the following information:

- a) The "line" to which you will connect the telephone equipment (that is, your telephone number), and

## Features—Front View

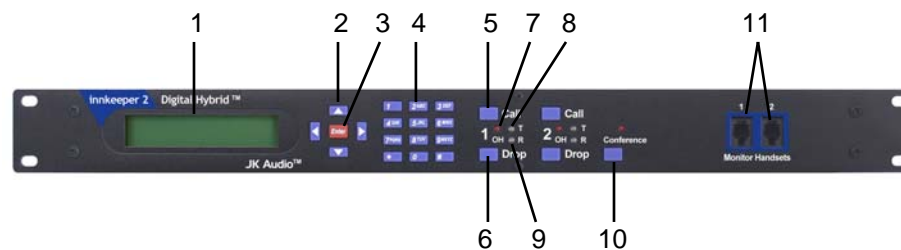

- 1 Backlit LDC menu display, 2x20 characters.
2. Directional Arrow Keys - Press these buttons to navigate through the menu.
3. Enter Button - Press this button to make a selection on the menu.
4. Keypad - Use these keys to dial a phone number or manually enter menu selection codes.
5. Call Buttons - Press these buttons to take the corresponding phone line off-hook or manually answer an incoming call.
6. Drop Buttons - Press these buttons to manually drop a call or place the corresponding phone line on-hook.
7. OH LED - Off-Hook LED lights when the corresponding phone line is off-hook or on line with a call. Also functions as a visual ring indicator and will flicker when ring voltage is present on the corresponding phone line.
8. Transmit LED - Bi-color Transmit LED will light green when audio is being sent down the corresponding phone line at -20 dB or greater signal level. LED will change to red to indicate clipping at -3 dB.
9. Receive LED - Bi-color Receive LED indicates that caller audio is present on the corresponding phone line at -20 dB or greater signal level if green and -3 dB or greater if red.
10. Conference button - Use this feature to conference together lines 1 and 2 when both lines are off-hook. This feature is available on innkeeper 2 only.
11. Monitor Handset Jacks - Used to connect an electret type handset for communication on the corresponding phone line.

## Features—Rear View



12. Phone Line Jack - RJ-11 phone line jacks for connection to analog phone lines.
13. Auxiliary Phone Jack - RJ-11 phone jacks for connection to analog telephone(s). Telephone(s) connected will only work with corresponding phone line jack. The auxiliary telephone should be used only for dialing and answering calls.
14. Caller XLR - Balanced line level XLR outputs containing Caller audio from the corresponding phone line.
15. Send XLR - Balanced line level XLR inputs used to send audio to the corresponding phone line.
16. Master Send - Balanced line level XLR input may send audio to any or all of the phone lines based upon controls set within the menu.
17. Remote Jack - Proprietary 10 pin RJ 50 for connection to a remote terminal interface. The included terminal block features an Off-Hook signal pin and a Call/Drop control pin for each channel. See pages 8-9. This jack can also be used for connection to the optional JK Audio RIU-IP remote interface (see page 16)
18. AC connector - For connection to 120 - 240 VAC, 50-60 Hz power.

## Specifications

<b>Inputs:</b>		
Line:	Balanced Female XLR, 20k ohm,	+10 dBu max
Master Send:	Balanced Female XLR, 20k ohm,	+10 dBu max
<b>Outputs:</b>		
Line:	Balanced Male XLR, 200 ohm,	+14 dBu max
<b>Handset:</b>		Front panel handset jacks biased for electret handset (not included)
<b>Phone Line:</b>		RJ11C
<b>Aux Phone:</b>		RJ11C
<b>Isolation:</b>		1500 VAC
<b>Ringer:</b>		0.5B REN
<b>Frequency Response:</b>		Telephone Side 200 Hz - 3600 Hz
<b>Power:</b>		120-240 VAC, 50-60 Hz Power supply (internal)
<b>Size:</b>		19" x 7.3" x 1.75" (26.7 x 18.6 x 4.5 cm)
<b>Weight:</b>		7.2 pounds (3.2 kg)
<b>Remote:</b>	Connector	RJ-50, 10 pin

## FAQ's

- ? **Can I plug a mic into one of the female XLR jacks?**  
 ! No, these are line level inputs only.
- ? **How do I adjust signal levels?**  
 ! The menu allows you to change input and output levels +/- 10dB.
- ? **What happens to the phone connection if power is momentarily interrupted?**  
 ! FCC and International telecom rules require that we drop the connection if power is lost for any period of time. We strongly suggest that you use a low cost, computer style UPS system if uninterrupted service is required.

## Optional Remote Interface Unit

### RIU-IP

The JK Audio Remote Interface Unit was designed for use with innkeeper 1x/1rx as well as innkeeper 2 and innkeeper 4 digital hybrids. This unit contains a web server which allows the user to send and receive control data through their web browser. RIU-IP can be connected to the user's computer NIC card for direct control, to a switch or hub for network control, or to an Ethernet port with internet access for control from anywhere in the world.

RIU-IP Features and Capabilities when used with innkeeper 1x:

- RJ45 Ethernet port
- RS-232 remote control port with simple ASCII protocol
- No external power required
- Indication of incoming ring per line.
- On-Hook and Off-Hook
- Confirmation of Off-Hook on On-Hook transition per line.
- Place call on hold or release hold.
- Dial (number) (line).
- Auto-Answer on/off
- Test tone start / stop per line.
- Presence on/off
- Caller Ducking on/off
- Automatic Gain Control on/off

Contact your JK Audio dealer for more information on this product.

## Connection—Mix-Minus Setup

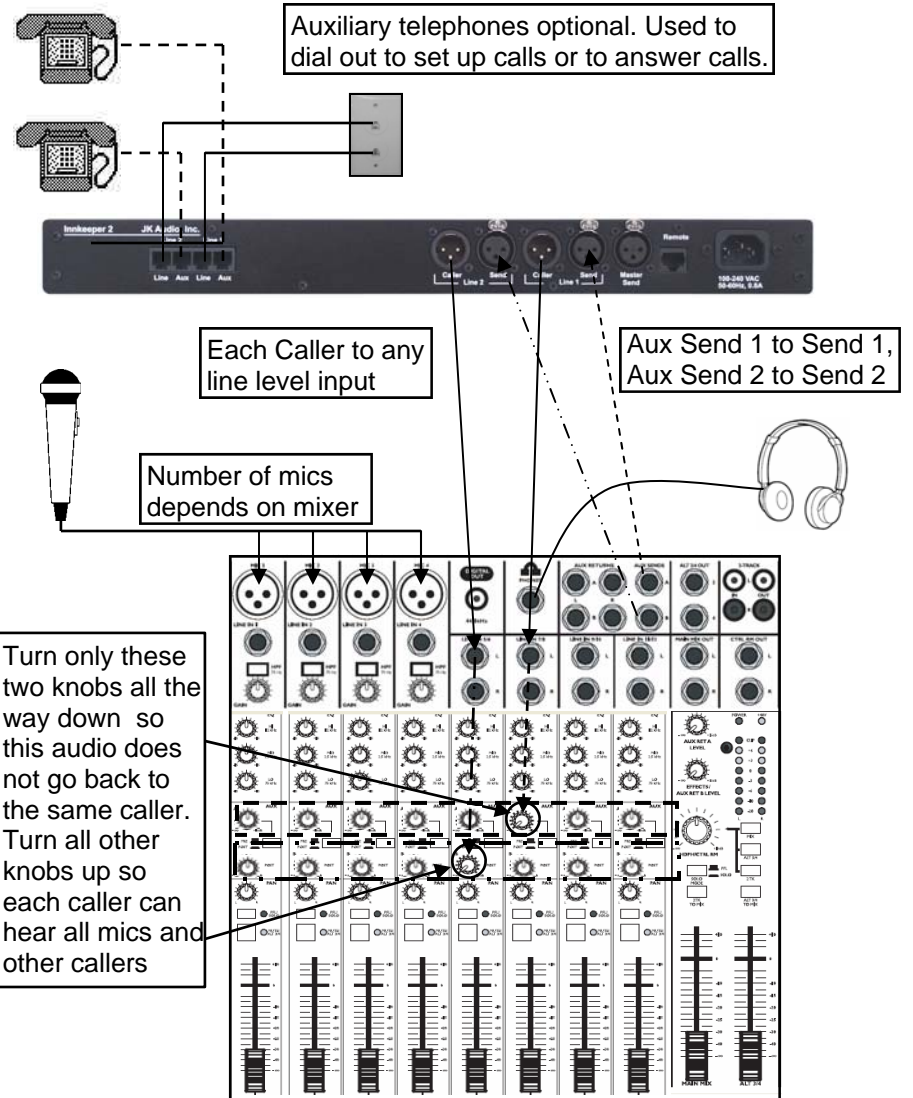

For whichever input channel you have each Caller connected to, turn the corresponding Aux control to minimum (usually hard left) so each Caller will not hear their own audio. Each Aux Send bus is completely separate from all other outputs, so each row of Aux controls will not affect what is heard on the Main outputs or on other Aux buses. If possible, the Aux Send buses should be pre-fader, so you can use the fader controls to set the levels of each channel to the main output. The innkeeper 2 was used in this example. Follow the same strategy for an innkeeper 4, with 4 Aux Send buses.

## Operation

### Connecting Cables

Although each application will require a slightly different setup, following is a general cable connection setup and explanation.

- **Phone Line** - Connect the supplied RJ11 phone line cable(s) between the RJ-11 jack(s) marked "Line" and your analog phone line jack(s). Be sure these jacks can support standard analog telephone operation. The innkeeper 2/4 will not work with "dry pair" phone line connections.
- **Send XLR** - Connect a line level (mix-minus) audio signal to the Send jack(s) on the innkeeper 2/4. Audio will be sent down only the corresponding phone line.
- **Master Send** - Connect a line level (mix-minus) audio signal to the Master Send input. Audio will be sent down either or both phone lines based upon your selections in the menu controls.
- **Caller XLR** - Connect Caller output(s) to line level input(s) on your audio equipment. Each caller output jack will contain audio only from its corresponding phone line. Local audio and audio from alternate phone lines will not be present on these jacks. Innkeeper 2 has the ability to send isolated caller audio, mixed caller audio, or mixed caller and local audio from the Caller XLR depending on selections made in the Conferencing menu.
- **Power** - Connect the supplied power cable to a 120 - 240 VAC power outlet.

### Auxiliary Telephone(s)

You can use an auxiliary telephone to place or screen a call, and then the call can be placed on hold. When you are ready to take the call on innkeeper 2/4, simply press the Call button for the corresponding phone line. Your telephone will automatically release the hold while you talk. If you need to take the call back on the auxiliary telephone, simply pick up the phone before the innkeeper 2/4 Drop button is pressed for that line.

## Operation - Conference Options

### Advanced Conference Options Signal Flow Diagrams

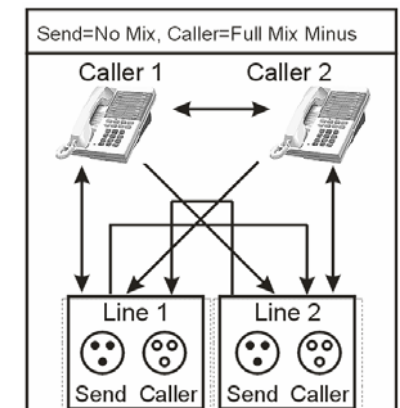
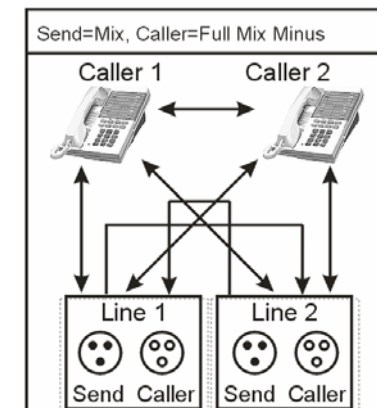
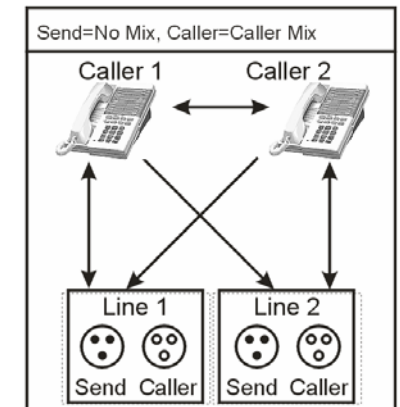
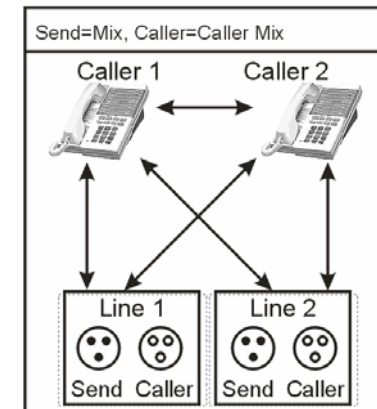
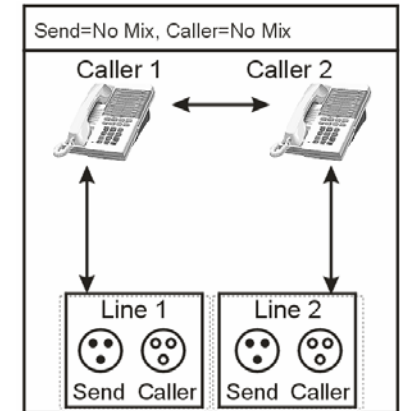
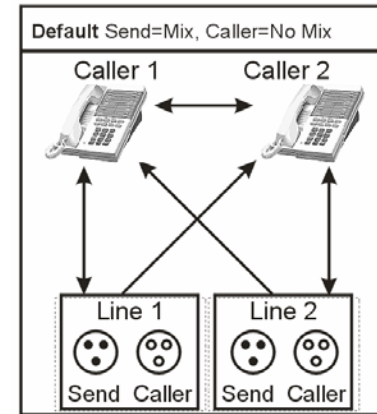

## Operation - Conference (innkeeper 2 only)

### Conference

One press of the conference button will join the audio paths of both line one and line two, provided there are calls present on both lines.

A second press of the conference button will break the audio paths between the calls. An auto-dropped or manually dropped line will automatically break the conference.

By default, line1 send and line send audio will be mixed together digitally and sent into both phone lines. Line 1 caller will hear line 2 caller audio. Line 2 caller will also hear line 1 caller audio. In the menu, this configuration is referred to as Send-Mix, Caller-No Mix. This default configuration is by far the most widely used. Advanced options are available for Conference mode; however for most situations it will not be necessary to change these default options.

### Innkeeper 2 Advanced Conference Options

The factory default conference mode provides both callers with a mix of Line 1 Send and Line 2 Send audio. Additional mix options can be found in the Configuration menu. These options allow you to enable and disable Send and Caller mix features. Keep in mind that no matter what options are selected, both callers will always be able to communicate with each other in Conference mode.

Send = Mix (default)

Line 1 Send and Line 2 Send audio mixed and sent to both caller lines.

Send = No Mix

Line 1 Send audio to line 1 caller

Line 2 Send audio to line 2 caller.

Caller = No Mix (default)

Line 1 caller audio only on the Line 1 caller output XLR

Line 2 caller audio only on the Line 2 caller output XLR.

Send audio will not be present on these outputs.

Caller = Caller Mix

Line 1 and Line 2 caller audio on both of the line 1 and line 2 caller XLR outputs. Send audio will not be present on these outputs.

Caller = Full Mix Minus

A full mix of all audio on each of the caller XLR outputs, minus the Send audio for that phone line.

Line 1 Caller XLR contains Caller 1 + Caller 2 + Send 2.

Line 2 Caller XLR contains Caller 1 + Caller 2 + Send 1.

## Operation (continued)

### Transmit Signals

The bi-color Send LED displays the signal level as it goes out over the phone line. The LED will display transmit signal levels at -20 dB as green and indicate clipping at -3 dB as red. The goal is to drive the phone line at high enough levels to avoid phone line noise, but not so loud as to cause excessive clipping. Adjust your Send audio signals to a level slightly less than the point where you see occasional flashes of red on the Transmit LED. These flashes should occur during loud speech bursts only. If the Transmit LED stays lit red for extended periods, you can assume that much of your speech is being clipped or distorted. In this case you should lower the audio levels for the signal that is causing the clipping. The innkeeper 2/4 menu will also allow you to adjust your input levels in 1 dB increments over a +/-10 dB range.

### Receive Signals

The bi-color Receive LED displays the signal coming from the phone line and out of the DSP. The LED will display receive signal levels at -20 dB as green up to -3 dB where it will change to red. The innkeeper 2/4 menu will allow you to adjust individual Caller output levels in 1 dB increments over a +/-10 dB range to give you the best signal level at your equipment. The Caller level control in the menu will not change what you see on the Receive LED.

### Auto-Answer

The Auto-Answer feature can be activated through the innkeeper 2/4 menu. You may select which phone lines will have auto-answer enabled as well as how many rings before auto-answer. When Auto-Answer is enabled, you can still take calls manually using the call button. When finished, you can either drop the call manually or allow the call to auto-disconnect. Innkeeper 2/4 will look for a CPC disconnect signal or ROH message from the phone company to determine when a call has disconnected. This can take up to a minute.

## Remote Jack

### Remote Jack

The 10 pin RJ-50 jack on the back of the innkeeper 2/4 provides a proprietary connection to the supplied remote terminal block. A 1 meter cable is provided for this connection. This jack can also be used to connect to the optional JK Audio RIU-IP remote interface unit (see page 16).

### Remote Terminal Block

A Remote Terminal Block has been provided in this package with a special 1 meter cable for connection to your innkeeper 2/4 multi-line digital hybrid.

The Remote Terminal Block includes an Off-Hook signal pin and a Call/Drop control pin for each phone line channel. The OH signal pin is current limited to 50 mA, 5 VDC. The control pin toggles the corresponding phone line off-hook/on-hook with a connection/break from ground.

This terminal block was designed to allow remote off-hook / on-hook control and status for each phone line. The innkeeper 2 model also provides on / off control and status for the Conference feature. Use only the included RJ-50 cable to connect the Remote Terminal Block to the Remote jack on the innkeeper 2/4.

Connecting the Line OH Control pin to the Ground pin will take the line off-hook, breaking this contact will release the line and disconnect the call.

The OH Status pin will provide 5V, 50mA current when the corresponding line is off-hook. You can use this pin to drive a relay, light an LED, etc.

## Operation - Menu Display (continued)

both Caller output jacks. Caller 1 and Caller 2 outputs will contain both Line 1 and Line 2 caller audio. The "Full Mix Minus" option provides a mix-minus signal output on both Caller output jacks. Caller 1 out will contain Line 1 caller audio, Line 2 caller audio and Send 2 audio. Caller 2 out will contain Line 1 caller audio, Line 2 caller audio and Send 1 audio.

**Config. Presets** (3,6) With this menu you can save and restore custom presets or reset the unit to factory default presets.

**Config. Presets - Default** (3,6,1) Here you may restore factory default presets. You will be prompted to confirm Factory Reset after selecting this option.

**Config. Presets - Custom** (3,6,2) Here you may save and restore custom presets based upon your current configuration.

These character sets are active only when entering the Name of your phone book entry. While entering the phone number you will not have access to alpha characters.

## Multi-Tap Key Legend

**Control Keys:**

- < Clear last character
- > Next / Accept current character
- \* Shift (press before each uppercase entry)
- # Space

**Character Keys:**

1	. @ ? ! - \ , & :
2	a b c 2
3	d e f 3
4	g h i 4
5	j k l 5
6	m n o 6
7	p q r s 7
8	t u v 8
9	w x y z 9

## Operation - Menu Display (continued)

**Config. Audio Levels Send (3,2,1)** Send input levels can be set for each line individually or all lines. These settings affect the independent Send input as well as the Master Send for the selected line(s).

**Config. Audio Levels Caller (3,2,2)** Caller output levels can be set here for each line independently or all lines.

**Config. Master Send (3,3)** This menu gives you the ability to turn the Master Send on or off for each line individually or all phone lines.

**Config. Calibration (3,4)** Here you can send a 1kHz test tone down the phone line(s) and the output jacks. You may turn the tone on or off for each line individually or for all lines. This is not required for setting the null. This tone is only for your convenience in setting your equipment audio levels.

**Conference (3,5) innkeeper 2 only.** This menu allows you to configure settings for the Conference feature. See pages 14-15

**Conf. Send Mix Mode (3,5,1) innkeeper 2 only.** Configure the Send Mix Mode to "Send Mix" default or "No Mix". The "Send Mix" default option mixes both the Line 1 Send and Line 2 Send audio signals together and sends that audio down both phone lines. The "No Mix" option does not mix these signals together. Line 1 Send audio will only go to Phone Line 1 and Line 2 Send audio will only go to Line 2. You may still use the Master Send input to send a common audio signal to both phone lines.

**Conf. Caller Mix Mode (3,5,2) innkeeper 2 only.** Configure the Caller Mix Mode to "No Mix" default, "Caller Mix" or "Full Mix Minus". The "No Mix" option does not mix any audio together on the Caller output jacks. Caller 1 out will contain Line 1 Caller audio and Caller 2 out will contain Line 2 Caller audio. The "Caller Mix" option mixes together both caller audio signals on

## Remote Terminal Block

### Terminal Block Pinout

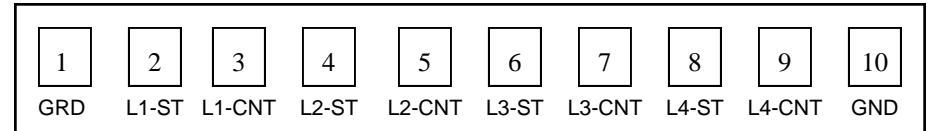

Terminal Number	Terminal Description
1	Ground
2	Line 1 - OH status signal (nominal +5Vdc @ 50ma, when active)
3	Line 1 - OH control (momentary to grd toggles lineon/offhook)*
4	Line 2 - OH status signal (nominal +5Vdc @ 50ma, when active)
5	Line 2 - OH control (momentary to grd toggles lineon/offhook)*
6	Line 3 - OH status signal (nominal +5Vdc @ 50ma, when active)
7	Line 3 - OH control (momentary to grd toggles lineon/offhook)*
8	Line 4 - OH status signal (nominal +5Vdc @ 50ma, when active)
9	Line 4 - OH control (momentary to grd toggles lineon/offhook)*
10	Ground

\* momentary or static line control selection for all lines is made via jumper J5

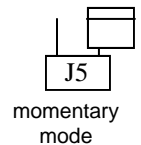

NOTE: Installation of jumper J5 will set "static" OH line control, so that a steady ground on any control input will take the corresponding line offhook, otherwise the line will remain onhook. Removal of jumper J5 will return OH line control to its original "momentary" control mode, so that any line control input that is momentarily brought to ground (for a min. of 100ms), will toggle/switch the corresponding line state between onhook or offhook, as determined by the given line's previous state.

## Operation - Menu Display

### Backlit Menu Display and Controls

The innkeeper 2/4 menu is controlled by the directional arrows, alpha numeric keypad and Enter button. You may use either the arrow keys to scroll through the menus or the keypad to directly select menus and use the Enter button or the keypad to make your selections. Through the menu you have access to the following. The ( ) indicate the numeric entry used to access these menus without scrolling. For example, to access the Call History View menu directly, you would press 2 Enter, 1 Enter.

**Phone Book (1)** A 50 entry name and number phone book for storing speed dial numbers.

**Phone Book View (1,1)** Allows you to view name and phone numbers of added entries. You may dial the selected entry from this menu by simply pressing the Call button on any phone line.

**Phone Book Add Entry (1,2)** You may add new entries from this menu. After pressing Enter you will be prompted for the phone number. You may enter a 2 second pause in your phone number entry by pressing the > key. Multiple > key presses will enter multiple 2 second pauses. The display will show a "." between the numbers for each 2 second pause entered. After the Enter key is pressed again you will be prompted for the entry Name. Alpha characters may be selected by using the multi-tap feature. For example, to enter the character "a" you would press the 2 key. To enter "b" you would press the 2 key twice. Hitting a new key, the Next> key or waiting 2 seconds will accept the current character and move the cursor forward. See page 10 for multi-tap key legend.

**Phone Book Delete Entry (1,3)** Entries may be deleted individually from this menu. You will be prompted to confirm delete of an entry.

**Phone Book Clear (1,4)** Press enter from this menu to clear all phone book entries. You will be prompted to confirm your

## Operation - Menu Display (continued)

intent to clear the entire phone book before deletion.

**Call History (2)** Calls you place will automatically be entered into the Call History menu. The Call History menu will hold up to 16 numbers.

**Call History View (2,1)** Allows you to view name and phone numbers of automatically added entries. You may dial the selected entry from this menu by simply pressing the Call button on any phone line.

**Call History Clear (2,2)** Press Enter from this menu to clear all automatically added history entries. You will be prompted to confirm your intent to clear the entire call history before deletion.

**Config. (3)** This menu allows you to control Auto-Answer, Auto-Disconnect, Audio Levels, Master Send, Calibration and Restore Factory Default or Custom Settings.

**Config. Auto-Answer (3,1)** Here you can configure Auto-Answer.

**Config. Auto-Answer On/Off (3,1,1)** This menu allows you to turn Auto-Answer on and off for each line independently or for all lines.

**Config. Auto-Answer Ring Count (3,1,2)** Select the number of rings before the unit auto-answers on each line individually or on all lines.

**Config. Audio Levels (3,2)** Audio levels for each phone line input and output can be set here. The Audio Levels menu allows you to adjust levels of audio in 1dB increments over a +/- 10dB range. You may adjust the levels of the Send inputs as well as the Caller outputs.